

10.1.5.1.

10.1.5.1.1.

... - e " ",
,
I- . 21 (-21) - , 2:
- , km:17+445.00 - km:34+205.00 " - 21",
=16.760km (km:18+179.57 - km:34+657.74 , =16.478km),
.
-

10.1.5.1.2.

II, -
,
,
AutoCad CIVIL 3D
()
,
e 6
- .
5m 50m,
50m
.

1 n .
.

:

..	1 - 57
..	1 - 950
..	1 - 10
..	1 - 78

II - . . . , - . . . -

. . . .

. 10.1.6.2

.

,

.

,

AutoCAD Civil 3D 2014

.

.

. 10.1.6.1.

.

. 10.1.7.1.

,

1:2500.

, 0.3mm,

.

10.1.7.2

,

.

1:2500

.

0.3mm,

,

.

,

—

.

.

:

,

-

,

,

,

,

,

10.1.6.3.

.10.1.6.4.

AutoCAD Civil 3D 2014

10.1.5.1.3.

(

)

()

10.1.6.5

167 a.

=160mm 50cm

=10mm.

10cm

(

40cm),

(),

2

10.1.5.1.4. Предмер и предрачун радова

Пројекат експропријације деоница 2			
Активност	Количина	цена (дин)	Укупно (дин)
геодетско обележавање и снимање линије експропријације, израда елабората експропријације	цела деоница		2.300.000,00
Приближна вредност експроприсаног земљишта	105 59 06 m ²	300,00	316.771.800,00
УКУПНО:			319.071.800,00

Датум:

14.09.2016.година



Милица Исаковић, дипл.инж.геод.

:					
:					
	ha	a	m ²		
8099		1	33		
8100/1		9	87		
8100/2		10	05		
8101		9	10		
8102		9	68		
8103		9	30		
12685		1	41		
12656	1	68	56		
7439		10	41		
7440		21	12		
7441		26	82		
7442		76	33		
7443		23	55		
12686/2		6	58		
8074		8	55		
8073		13	72		
8072/2		6	60		
8072/1		7	24		
8070		25	88		
7445/4		16	61		
7445/3		12	89		
7444/1		12	90		
7444/2		36	44		
7445/5		15	22		
12687		1	80		

:					
:					
	ha	a	m ²		
3445		80	26		

:					
:					
	ha	a	m ²		
3/1		63	68		
660		19	44		
661		42	69		
618		3	78		
617		58	60		
662		7	58		
697		5	65		
694		3	97		
693		5	72		
692		10	39		
695		13	55		
696		12	38		
663		5	03		
698		15	56		
699		57	71		
691		31	52		
690		6	69		
700		10	48		
701		14	79		
702		12	86		
703		44	93		
829		15	34		
849		10	21		
704		20	91		
705		14	63		
827		7	48		
828		20	11		
825		15	30		
824/2		4	66		
830		65	34		
833		40	81		
834		74	50		
832		31	30		
841		20	83		
840		7	66		
838		6	16		
839		27	50		
837		16	29		
858			89		
859		1	35		
857		1	06		
856			65		
850		7	31		

	ha	a	m ²		
849		84	06		
851		26	10		
848		30	86		
847		13	75		
846		23	26		
845		17	95		
844		49	40		
843		13	28		
994			60		
993		18	21		
992		2	23		
990		53	46		
999		2	25		
1000		1	15		
1003		29	75		
1002		20	48		
1010		28	42		
1011		22	71		
1007		2	27		
1012		1	28		
1013		4	38		
1014		8	40		
1015/1		67	57		
1015/2		2	72		
1016		45	90		
978		3	33		
9711		1	55		
1031/1		18	48		
1021		29	46		
1022		4	31		
1023		41	91		
1389/2		5	31		
1389/1		22	06		
1390		16	41		
1391		17	28		
1392		11	92		
1393		15	72		
1394		17	40		
1397		4	82		
1396		50	36		
1386		1	41		
1385		66	77		
1368		12	93		
1361		19	74		
1362		6	30		
1367		4	65		
1360		16	52		

	ha	a	m ²		
1370		11	22		
1371		2	27		
1359		1	85		
1358		11	84		
1357		19	20		
1355		2	06		
1354		16	87		
1352/2		7	53		
1352/1		12	19		
1353		17	46		
1321		7	14		
1323		5	64		
1322/1		77	38		
9747		37	92		
1308		14	60		
1326/1		1	92		
1326/2		3	47		
1322/2		6	84		
1326/3		3	25		
1307		11	80		
1300		27	85		
1325/3		6	28		
1327		2	61		
1328		19	50		
1299		7	40		
1329		18	42		
1330		17	04		
1298		1	49		
1524			67		
1521		1	87		
1525		11	28		
1526		14	77		
1527		2	74		
1533		4	02		
1530		14	69		
1532		18	32		
1531		1	41		
1514		10	79		
1542/2		24	05		
1542/1		16	06		
1541/1		1	87		
1540/1			24		
1515		1	38		
1516/1		5	78		
1543		14	56		
1544/1		5	86		
1513		51	32		

	ha	a	m ²		
1512		1	64		
3764/1		8	26		
3765		28	87		
3766		16	14		
3773		59	52		
3772		1	78		
3771		1	25		
3775		5	77		
3776		7	17		
3763		32	48		
3777		39	05		
3778		19	31		
3781			4		
3780			11		
3779		14	72		
4045		10	29		
4046			43		
4061		10	04		
4062		13	22		
4064			73		
4065			68		
4066			49		
4067			56		
4056		1	04		
4057		16	19		
4054		26	29		
4055		2	17		
4051		5	32		
4050			84		
4049		13	23		
4048		22	44		
4032		15	43		
4033		24	05		
4029		2	67		
4027		49	59		
4024		58	66		
4023		5	57		
9764		24	63		
9768/1		1	74		
4022			89		
3982		2	21		
4021		27	46		
4020		17	48		
4167		5	06		
4172		6	89		
4173		4	45		
4176/1			69		

	ha	a	m ²		
4018		1	50		
4019		11	64		
4016		59	47		
4017		9	43		
9768/1		36	93		
4233		5	92		
4234/1		7	96		
4234/2		1	38		
4235/2		12	85		
4236/1		7	84		
4236/2		4	84		
4231		13	58		
4230		5	74		
4229		7	15		
4228			48		
4237		5	05		
4239		5	19		
4222		23	35		
4223		12	57		
4238		6	06		
4240		6	76		
4243		6	35		
4220		3	61		
4221		6	33		
4211		6	61		
4244		10	46		
4245		5	61		
4246		5	20		
4306		3	20		
4304		2	03		
4307		5	30		
4210		12	89		
4308		10	62		
4310		11	54		
4311		2	79		
4316		35	29		
4312		9	91		
4313		12	75		
4315		3	51		
4327/1		25	86		
4343/1	1	09	34		
4328/1		3	30		
4328/3			26		
4331/1		2	17		
4331/3			80		
4332/1		1	79		
4332/3		2	00		

	ha	a	m ²		
4333/1			54		
4333/3		2	56		
4341/2		5	82		
4342/2		1	01		
4343/2		16	16		
9768/3		12	11		
4542/2		9	31		
4549/2		13	83		
4532/2		4	79		
4541/3		15	64		
4541/2		2	97		
9768/2		8	05		
4541/1		2	31		
4532/1		1	14		
4542/1		4	56		
4549/1		3	57		
4540/1		16	03		
4540/3		15	28		
4540/2		3	03		
4538/1		8	21		
4538/3		5	36		
4538/2			75		
4539/1		5	05		
4539/3		3	07		
4539/2			61		
4537/1		4	49		
4537/2		6	04		
4534/2			9		
4536			82		
4535/2		2	66		
4505/2		16	12		
4507/2		1	32		
4505/1		4	64		
4507/1		2	42		
9730/2		3	89		
9730/3		19	94		
9730/1		8	17		
4448		1	82		
4449/1		17	42		
4449/2			93		
4449/3		2	80		
9770/4		27	36		
4504		4	04		
4503		2	54		
9770/3			51		
4450/1		8	72		
4450/2			6		

	ha	a	m ²		
4502/2		7	74		
4502/1		3	82		
4451/1		3	84		
4452/1		3	94		
4453/1		5	88		
4454/1		4	65		
4455/1		1	41		
4456/1		2	61		
4457/1		2	85		
4458/1		2	43		
4459/1		1	16		
4460/1		1	44		
4461/1		2	04		
4462/1		2	76		
4464/1		3	80		
4465/1		1	94		
4466/1		2	09		
4467/1		2	29		
4468/1		2	50		
4469/1			67		
4900/1		3	58		
4901/1		3	57		
4902/1		2	42		
4903/1		1	15		
4903/2		1	12		
4899/1		1	67		
4904/1		1	32		
4905/1		2	06		
4906/1		1	74		
4907/1		1	51		
4908/1			96		
4909/1			87		
4910/1		1	98		
4911/1		1	28		
4912/1			82		
4913/1		1	18		
4914/1		1	16		
4915/1		4	56		
4916/1		3	05		
4917/1		5	41		
4918/1		3	19		
4919/1		3	48		
4920/1		2	25		
4921/1		2	34		
4922/1		3	25		
4922/3			51		
4885/1			18		

	ha	a	m ²		
4885/2		9	08		
4885/1			18		
4886/1			10		
4886/2			62		
4898/2		1	13		
9770/5		19	28		
9770/2		15	77		
4470		1	22		
4474			7		
4475			26		
4476			62		
4478		1	70		
4481		1	24		
4482			87		
4485		1	17		
4486/1			38		
4486/2			10		
4488/1		1	92		
4489/1			98		
4490/1		1	08		
4492/1		2	59		
4494/1			90		
4495/1			89		
4498/1		1	00		
4499/1			44		
4500/1			43		
4501/1		1	35		
4501/2		2	12		
4500/2			71		
4499/2		1	72		
4498/2		1	78		
4495/2		1	63		
4494/2		1	72		
4492/2		3	86		
4490/4		1	23		
4489/2			87		
4488/2		1	32		
9770/4		29	18		
4451/2			55		
4452/2			89		
4453/2		1	55		
4454/2		1	41		
4455/2			46		
4456/2			90		
4457/2		1	09		
4458/2		1	07		
4459/2			55		

	ha	a	m ²		
4460/2			67		
4461/2		1	09		
4462/2		1	50		
4464/2		2	27		
4465/2		1	33		
4466/2		1	52		
4467/2		1	75		
4468/2		2	06		
4469/2			61		
4900/2		3	45		
4901/2		3	88		
4902/2		2	88		
4903/3		1	35		
4903/4		1	31		
4899/2		1	96		
4904/2		1	86		
4905/2		2	82		
4906/2		2	44		
4907/2		2	42		
4908/2		1	65		
4909/2		1	44		
4910/2		3	25		
4911/2		2	00		
4912/2		1	27		
4913/2		1	70		
4914/2		1	53		
4915/2		5	73		
4916/2		3	90		
4917/2		7	48		
4918/2		3	63		
4919/2		2	51		
4920/2			88		
4921/2			56		
4922/2			38		
4871/2		1	00		
4923/1		7	09		
4923/2		7	70		
9799/2		6	47		
4971/2		3	84		
4971/1		2	66		
4927/1		3	73		
4927/2		4	16		
4928/1		6	88		
4928/3		9	05		
4928/2			20		
9799/1		16	28		
4950/1		3	41		

	ha	a	m ²		
4950/2			66		
4950/3		4	48		
4951/1		3	41		
4951/2		1	03		
4951/3		4	45		
4952/1		3	34		
4952/2		1	21		
4952/3		4	38		
4954/1		6	76		
4954/2		2	30		
4954/3		9	00		
4955/1		1	63		
4956/1		1	40		
4957/1		3	16		
4955/2			48		
4955/3		2	28		
4956/2			34		
4956/3		1	93		
4957/2			52		
4957/3		4	37		
4964			11		
4964			26		
4967			21		
4968			31		
4970			10		
4972/1			13		
4972/2			81		
9800/1			94		
9800/2			20		
9800/3		1	38		
6689/1		1	54		
6689/2			24		
6689/3		2	22		
6688/1		1	44		
6688/2			18		
6688/3		2	15		
6687/1		2	77		
6687/2			20		
6687/3		4	07		
6686/1		1	60		
6686/2			3		
6686/3		2	44		
6685/1		1	37		
6685/2		2	03		
6684/1		2	89		
6684/2		4	27		
6683/1		2	64		

	ha	a	m ²		
6683/2		3	53		
6682/1		3	06		
6682/2		3	60		
6679/1		3	29		
6679/2		3	56		
9799/4		10	93		
6678/1		6	55		
6678/2		6	64		
6677/1		3	22		
6677/2		3	18		
6676/1		3	13		
6676/2		2	72		
6675/1		3	63		
6675/2		2	98		
6674/1		3	38		
6674/2		2	48		
6673/1		7	69		
6673/2		4	45		
6628			25		
6630			41		
6631			59		
6633			94		
6634			91		
6635		1	01		
6636		1	28		
6637		1	34		
6639		1	50		
6640		1	52		
6642		1	81		
6643/1		3	43		
6643/2			27		
6644/1		2	19		
6644/2			49		
6645/1		10	51		
6645/2		2	44		
6645/4		16	68		
6645/3		3	37		
6660/1		22	05		
6659/2		1	04		
6660/2		5	51		
6646		8	22		
6662		6	13		
6663/1		56	00		
6663/2		22	92		
9799/3		11	32		
6672/1		5	80		
6672/2		2	32		

	ha	a	m ²		
6671/1		10	64		
6671/2		2	55		
6670/1		19	38		
6670/2		1	89		
6669/1		15	24		
6669/2		24	91		
6668/1		18	00		
6668/2			59		
6667/1		6	45		
6667/2		13	40		
6667/3			48		
6666/2		13	89		
6665		24	70		
6664/1		24	11		
6664/2			16		
97271/		73	73		
12010/1			6		
6658		8	34		
9724/1	6	65	47		
6739/1		32	95		
6739/2		5	05		
6738/2		8	70		
6737		8	83		
6736		5	08		
6735/2		7	09		
6735/1		6	15		
6734/2		5	25		
6734/1		4	58		
6733		7	03		
6732		6	66		
6731		9	81		
6730		6	60		
6729		13	75		
6884		3	52		
6885/12		3	60		
6885/13		6	49		
6885/15		11	51		
6885/14		11	95		
6885/2		16	72		
6885/3		23	05		
6885/4		24	66		
6885/5		26	14		
6885/6		11	45		
6885/7		17	19		
6885/8		14	74		
6885/9		14	89		
6885/10		15	01		

	ha	a	m ²		
6885/11		14	17		
7062/1		36	12		
7062/2		37	92		
7063		59	87		
7064		29	50		
7065		95	70		
9724/2	9	72	31		
7066		3	29		
7067		3	64		
7068		10	13		
7069/1		7	38		
7069/2		6	48		
7070		7	39		
7071/1		8	02		
7071/2		5	64		
7072		7	64		
7073		14	39		
7074		8	08		
7075		7	52		
7076/2		7	70		
7076/1		7	59		
7077		7	89		
7078		6	11		
7079		7	43		
7080		11	11		
7081		6	16		
7082		7	16		
7083		10	19		
7084/2		6	94		
7084/1		1	58		
7093		4	73		
7094		1	48		
7095/1		19	18		
7095/2		18	08		
7095/3		10	95		
7095/4		10	59		
7095/5		32	23		
7095/6		31	83		
7095/7		35	39		
7095/8		34	38		
7095/10		49	79		
7095/11		9	33		
7095/21		18	74		
7095/12		28	18		
7095/13		27	85		
7095/14		17	75		
7095/15		45	51		

	ha	a	m ²		
7095/16		5	22		
7095/17		19	13		
7095/18		14	05		
7095/20		1	90		
7095/19	3	33	09		
7095/22		88	52		
7097		3	28		
7096		60	88		
9804		2	80		
6740/1		10	12		
6740/2		8	23		
6741/2		7	40		
6742/2		5	23		
6743/2		4	02		
6741/1			97		
6743/1		1	32		
6744/2			85		
6744/1		48	43		
6749		41	84		
6745		1	69		
6867		19	95		
6872/17		1	86		
6871/1		26	98		
6872/1		8	87		
6872/18		4	48		
6872/5		3	17		
6872/16		3	11		
6872/6		3	21		
6872/7		8	14		
6872/8		3	68		
6872/9		14	96		
6872/10			65		
6872/21		14	28		
6872/19			97		
6872/20		3	32		
6872/4		10	83		
6872/2			9		
6872/3		7	22		
6872/13		9	59		
6873		90	24		
6874/6			64		
6874/7		2	78		
6876/1		6	93		
6883/3		44	56		
6883/19		11	88		
6883/4		16	14		
6883/20		15	90		

	ha	a	m ²		
6883/1		8	62		
6883/11		7	96		
6883/12		7	64		
6883/13		7	78		
6883/14		7	68		
6883/15		7	20		
6883/16		11	44		
9807/1		3	13		
7127		2	16		
7126		2	58		
7125		2	46		
7124		1	18		
7123		2	32		
7122		2	43		
7121		2	45		
7120		1	17		
7119		1	56		
7118		2	40		
7117		2	02		
7116		3	83		
7115/1		2	51		
7114/1		2	54		
7113		2	72		
7112		2	07		
7111/2		6	42		
7111/1		1	77		
7110		2	44		
7109		2	38		
7108		2	65		
7107		2	54		
7106		2	72		
7105		2	34		
7104/1		1	27		
7104/2		1	21		
7103		2	30		
7102		2	67		
7101		1	12		
7100		2	36		
7099		1	34		
7098		4	60		
9121		2	84		
9120		3	57		
9114/1		15	69		
9113		2	63		
9112		91	12		
9111		2	59		
9110		2	68		

	ha	a	m ²		
9109		2	49		
9108		2	55		
9107		2	43		
9106/1		2	69		
9106/2		1	21		
9105		1	37		
9104		5	40		
9103/1		2	81		
9102		2	62		
9101		2	73		
9100		5	58		
9103/2		2	25		
9099		2	49		
9098		2	51		
9097		2	70		
9096		2	79		
9095		2	80		
9094		2	77		
9093		2	67		
9092		3	29		
9091		4	22		
9162		3	10		
9163		4	63		
9164		3	02		
9165		1	49		
9166		3	24		
9167		3	27		
9168		2	92		
9169		3	23		
9170		2	87		
9171		2	69		
9172		2	78		
9173		2	66		
9174		2	76		
9175		1	24		
9176		2	59		
9177		3	88		
9178		2	46		
9179		1	43		
9180		4	50		
9181		4	01		
9182		2	27		
9183		2	70		
9184		1	20		
9185		3	32		
9186		1	19		
9187		1	09		

	ha	a	m ²		
9188		1	41		
9189		2	03		
9190		3	51		
9191		2	12		
9192		2	22		
9193		2	59		
9194		2	39		
9195		3	22		
9196		2	05		
9197		3	26		
9198		2	00		
9199		1	07		
9200		3	16		
9201		3	20		
9202		1	81		
9203		1	61		
9204			97		
9216		1	65		
9217		1	54		
9218		1	56		
9219		10	32		
9220		10	30		
9221		10	44		
9222/1		6	80		
9222/2		9	89		
9222/3		12	04		
9222/4		4	82		
9222/5		44	19		
9808/2			90		
9223/1		12	46		
9223/2		11	88		
9223/3		10	28		
9223/4		4	27		
9223/5		5	59		
9223/6		5	85		
9223/7		8	42		
9223/21		9	18		
9223/8		25	00		

:					
:					
	ha	a	m ²		
3945	3	46	45		
3946		14	94		
3952/1		50	28		
3953		88	38		
3954		2	64		
3955		76	86		
3956		4	08		
3957		28	30		
3958		2	50		
3959		1	35		
3961		2	34		
3962		34	68		
3998		93	91		
4003		31	02		
4014		89	36		
4021		5	70		

.		
	Y [m]	X [m]
1	7408789.88	4988593.53
2	7408794.56	4988609.60
3	7408803.53	4988640.36
4	7408811.38	4988668.00
5	7408819.54	4988697.08
6	7408827.25	4988724.66
7	7408828.40	4988728.78
8	7408837.30	4988759.45
9	7408846.20	4988790.11
10	7408854.95	4988821.37
11	7408863.69	4988852.63
12	7408874.49	4988890.64
13	7408885.29	4988928.65
14	7408892.54	4988956.49
15	7408893.03	4988985.33
16	7408878.18	4989028.98
17	7408858.56	4989067.93
18	7408838.30	4989108.37
19	7408834.07	4989123.50
20	7408835.80	4989136.19
21	7408836.40	4989140.57
22	7409071.55	4989213.33
23	7409072.44	4989185.86
24	7409080.13	4989142.73
25	7409081.66	4989116.27
26	7409080.35	4989097.50
27	7409079.37	4989083.55
28	7409065.12	4989028.91
29	7409054.04	4988990.12
30	7409048.98	4988976.34
31	7409029.72	4988935.72
32	7409003.83	4988908.87
33	7408978.90	4988883.26
34	7408947.71	4988842.96
35	7408938.48	4988817.01
36	7408924.14	4988776.67
37	7408912.40	4988739.57
38	7408901.29	4988703.95
39	7408889.29	4988664.55
40	7408877.29	4988625.15
41	7408861.36	4988572.54
42	7408843.91	4988567.31
43	7408817.00	4988575.01
44	7408797.94	4988580.47
45	7408916.14	4989002.44

.		
	Y [m]	X [m]
46	7408898.18	4989046.60
47	7408878.77	4989093.25
48	7408858.99	4989143.32
49	7408900.22	4989155.86
50	7408941.45	4989168.40
51	7408982.11	4989181.21
52	7408984.87	4989177.99
53	7408980.22	4989152.43
54	7408972.90	4989137.75
55	7408962.46	4989103.81
56	7408953.79	4989075.20
57	7408944.80	4989045.52
58	7408931.61	4989004.23
59	7408936.17	4988869.48
60	7408946.34	4988908.77
61	7408963.02	4988948.61
62	7408969.41	4988959.25
63	7408964.89	4988972.55
64	7408977.58	4989015.22
65	7408991.89	4989063.35
66	7409004.38	4989105.34
67	7409011.02	4989112.58
68	7409019.66	4989143.82
69	7409028.29	4989175.05
70	7409058.02	4989172.12
71	7409064.40	4989134.92
72	7409064.59	4989107.35
73	7409060.07	4989074.79
74	7409048.37	4989034.98
75	7409036.67	4988995.17
76	7409026.34	4988969.03
77	7408991.94	4988923.51
78	7408964.29	4988896.68

.		
	Y [m]	X [m]
1	7408843.53	4989157.59
2	7408854.39	4989169.86
3	7408869.75	4989179.21
4	7408914.29	4989186.19
5	7408938.24	4989190.89
6	7408965.35	4989207.18
7	7408971.79	4989225.55
8	7408988.30	4989272.66
9	7409002.22	4989320.49
10	7409014.51	4989365.20

	Y [m]	X [m]
1	7408206.79	4999968.27
2	7408214.10	4999924.30
3	7408226.25	4999890.48
4	7408249.71	4999865.54
5	7408271.58	4999841.41
6	7408293.51	4999819.79
7	7408307.78	4999805.64
8	7408316.66	4999796.10
9	7408328.03	4999787.00
10	7408321.13	4999779.22
11	7408321.43	4999776.75
12	7408334.33	4999763.76
13	7408349.72	4999749.61
14	7408365.14	4999732.76
15	7408377.81	4999717.50
16	7408412.48	4999688.63
17	7408374.86	4999658.76
18	7408361.75	4999675.72
19	7408336.50	4999660.93
20	7408311.24	4999646.14
21	7408279.89	4999627.19
22	7408248.57	4999608.21
23	7408259.65	4999594.33
24	7408285.93	4999562.66
25	7408307.95	4999536.88
26	7408329.97	4999511.09
27	7408337.27	4999500.42
28	7408352.84	4999491.21
29	7408384.08	4999474.91
30	7408392.32	4999469.77
31	7408400.00	4999473.73
32	7408446.80	4999496.13
33	7408461.01	4999502.85
34	7408483.49	4999513.63
35	7408460.66	4999560.23
36	7408437.84	4999606.84
37	7408406.34	4999639.22
38	7408432.00	4999683.57
39	7408452.25	4999652.74
40	7408472.50	4999621.91
41	7408495.49	4999576.73
42	7408512.95	4999539.53
43	7408530.40	4999502.32
44	7408540.92	4999477.96
45	7408549.17	4999443.79
46	7408549.33	4999403.80

	Y [m]	X [m]
47	7408547.25	4999402.62
48	7408541.30	4999358.18
49	7408543.18	4999339.23
50	7408566.88	4999317.19
51	7408590.59	4999295.16
52	7408618.17	4999257.70
53	7408618.88	4999254.62
54	7408633.34	4999205.78
55	7408647.80	4999156.95
56	7408665.79	4999106.48
57	7408679.99	4999061.21
58	7408686.30	4999025.72
59	7408697.46	4999012.67
60	7408716.32	4998978.59
61	7408729.16	4998958.74
62	7408733.64	4998905.18
63	7408757.76	4998878.73
64	7408768.44	4998867.02
65	7408766.86	4998830.89
66	7408765.99	4998810.90
67	7408768.00	4998806.96
68	7408775.67	4998791.64
69	7408801.31	4998757.48
70	7408818.06	4998731.39
71	7408821.01	4998728.34
72	7408828.25	4998719.19
73	7408845.06	4998680.90
74	7408865.51	4998638.69
75	7408847.11	4998631.12
76	7408837.24	4998628.73
77	7408808.54	4998617.43
78	7408810.66	4998612.48
79	7408819.69	4998603.55
80	7408838.43	4998585.03
81	7408879.07	4998568.00
82	7408889.78	4998571.25
83	7408906.69	4998564.92
84	7408915.98	4998564.00
85	7408927.67	4998536.15
86	7408939.36	4998508.30
87	7408938.96	4998484.59
88	7408938.13	4998473.99
89	7408937.76	4998453.30
90	7408945.54	4998426.94
91	7408955.63	4998401.71
92	7408979.14	4998399.21

	Y [m]	X [m]
93	7408999.19	4998406.14
94	7409015.58	4998375.19
95	7409035.25	4998336.48
96	7409046.16	4998315.23
97	7409057.87	4998292.55
98	7409061.29	4998279.84
99	7409077.05	4998248.79
100	7409081.57	4998238.26
101	7409099.07	4998200.31
102	7409109.68	4998173.42
103	7409118.34	4998149.80
104	7409130.28	4998129.65
105	7409131.93	4998126.87
106	7409143.46	4998107.42
107	7409151.74	4998088.26
108	7409163.66	4998059.18
109	7409169.75	4998038.85
110	7409180.30	4998012.09
111	7409181.07	4997986.09
112	7409189.03	4997956.98
113	7409204.73	4997915.80
114	7409216.80	4997876.52
115	7409232.47	4997868.22
116	7409237.09	4997866.21
117	7409251.78	4997832.33
118	7409261.88	4997807.07
119	7409271.99	4997781.81
120	7409280.51	4997757.89
121	7409286.20	4997741.83
122	7409300.21	4997694.06
123	7409304.38	4997689.27
124	7409328.79	4997638.07
125	7409329.46	4997634.67
126	7409331.11	4997626.38
127	7409337.82	4997592.47
128	7409341.82	4997583.10
129	7409353.55	4997556.53
130	7409360.51	4997538.51
131	7409371.27	4997515.82
132	7409378.51	4997489.62
133	7409379.73	4997464.93
134	7409380.50	4997449.28
135	7409383.63	4997441.51
136	7409397.79	4997406.52
137	7409407.97	4997379.35
138	7409409.57	4997376.42

	Y [m]	X [m]
139	7409415.29	4997361.40
140	7409422.04	4997344.34
141	7409427.82	4997319.18
142	7409430.99	4997310.90
143	7409444.62	4997275.39
144	7409458.79	4997237.98
145	7409466.07	4997215.25
146	7409479.77	4997172.18
147	7409467.00	4997159.98
148	7409460.22	4997153.34
149	7409471.77	4997129.50
150	7409472.79	4997121.21
151	7409472.93	4997117.24
152	7409471.94	4997094.40
153	7409478.27	4997072.17
154	7409487.40	4997060.80
155	7409516.04	4997059.47
156	7409519.93	4997046.43
157	7409528.62	4997017.15
158	7409540.32	4996977.35
159	7409553.86	4996929.17
160	7409567.53	4996881.30
161	7409565.38	4996866.29
162	7409564.54	4996860.47
163	7409565.11	4996857.11
164	7409573.10	4996817.14
165	7409574.57	4996811.50
166	7409581.92	4996783.77
167	7409589.26	4996756.09
168	7409597.88	4996720.41
169	7409604.07	4996696.49
170	7409610.54	4996670.95
171	7409617.88	4996641.38
172	7409625.43	4996610.39
173	7409632.27	4996582.19
174	7409643.43	4996536.41
175	7409649.24	4996511.80
176	7409654.84	4996488.32
177	7409658.60	4996473.98
178	7409660.84	4996464.71
179	7409666.77	4996441.25
180	7409677.44	4996395.73
181	7409688.78	4996349.05
182	7409691.30	4996338.12
183	7409699.84	4996301.03
184	7409712.11	4996254.60

	Y [m]	X [m]
185	7409715.31	4996241.65
186	7409724.82	4996199.36
187	7409737.91	4996151.15
188	7409749.99	4996102.58
189	7409761.77	4996054.03
190	7409774.43	4996005.59
191	7409786.52	4995956.59
192	7409799.39	4995907.08
193	7409815.95	4995858.12
194	7409836.16	4995810.50
195	7409859.52	4995764.29
196	7409870.83	4995741.87
197	7409880.62	4995702.47
198	7409885.72	4995680.34
199	7409862.52	4995679.71
200	7409843.06	4995680.43
201	7409845.86	4995669.73
202	7409872.83	4995658.99
203	7409899.80	4995648.24
204	7409917.04	4995639.03
205	7409937.03	4995634.19
206	7409957.55	4995634.77
207	7409977.02	4995608.31
208	7409983.47	4995599.54
209	7410010.47	4995574.27
210	7410024.68	4995560.94
211	7410039.20	4995547.25
212	7410060.97	4995526.61
213	7410077.96	4995510.14
214	7410083.03	4995505.22
215	7410092.69	4995495.84
216	7410103.22	4995485.52
217	7410112.46	4995476.45
218	7410116.93	4995472.06
219	7410122.76	4995466.33
220	7410130.70	4995458.46
221	7410141.41	4995447.63
222	7410156.73	4995432.12
223	7410164.74	4995423.90
224	7410173.24	4995414.81
225	7410182.65	4995404.73
226	7410193.75	4995392.84
227	7410196.65	4995389.72
228	7410212.38	4995371.40
229	7410228.76	4995352.25
230	7410239.25	4995338.84

	Y [m]	X [m]
231	7410244.18	4995332.54
232	7410248.96	4995326.42
233	7410256.50	4995316.77
234	7410261.86	4995309.00
235	7410270.19	4995296.26
236	7410277.22	4995285.48
237	7410283.53	4995275.82
238	7410287.03	4995269.24
239	7410289.97	4995263.19
240	7410296.34	4995250.10
241	7410300.28	4995242.00
242	7410302.73	4995236.96
243	7410306.16	4995229.85
244	7410309.21	4995223.03
245	7410320.95	4995196.74
246	7410328.39	4995178.97
247	7410340.20	4995147.68
248	7410346.82	4995128.04
249	7410353.63	4995106.45
250	7410357.88	4995092.43
251	7410361.62	4995077.49
252	7410366.31	4995058.72
253	7410367.91	4995052.28
254	7410369.42	4995045.93
255	7410370.18	4995042.28
256	7410379.92	4994991.43
257	7410382.82	4994967.74
258	7410387.82	4994926.05
259	7410390.18	4994906.02
260	7410392.59	4994885.96
261	7410394.96	4994866.24
262	7410400.07	4994825.67
263	7410401.35	4994815.76
264	7410402.45	4994807.11
265	7410404.98	4994787.20
266	7410405.73	4994781.29
267	7410407.08	4994771.44
268	7410408.21	4994762.13
269	7410410.40	4994743.92
270	7410411.67	4994733.45
271	7410412.76	4994724.37
272	7410415.08	4994705.15
273	7410416.19	4994687.76
274	7410417.29	4994668.62
275	7410418.57	4994649.42
276	7410422.39	4994612.32

	Y [m]	X [m]
277	7410424.47	4994594.15
278	7410426.70	4994576.44
279	7410429.24	4994556.21
280	7410430.97	4994537.52
281	7410433.58	4994497.92
282	7410432.40	4994471.79
283	7410423.80	4994435.92
284	7410390.28	4994395.57
285	7410376.35	4994374.20
286	7410371.23	4994353.46
287	7410369.47	4994333.83
288	7410370.88	4994309.76
289	7410386.61	4994269.83
290	7410392.40	4994252.90
291	7410371.06	4994237.03
292	7410343.00	4994216.15
293	7410340.09	4994213.42
294	7410324.72	4994203.18
295	7410294.67	4994182.81
296	7410259.64	4994158.43
297	7410279.50	4994138.35
298	7410300.80	4994152.60
299	7410315.48	4994162.95
300	7410337.92	4994178.77
301	7410356.40	4994191.80
302	7410394.94	4994219.33
303	7410407.28	4994216.32
304	7410399.87	4994178.78
305	7410396.10	4994158.49
306	7410392.11	4994135.63
307	7410389.57	4994121.25
308	7410385.25	4994100.38
309	7410381.41	4994081.83
310	7410377.64	4994066.03
311	7410373.15	4994050.47
312	7410364.47	4994025.30
313	7410351.26	4994001.19
314	7410342.27	4993988.30
315	7410328.01	4993966.24
316	7410317.15	4993945.33
317	7410310.93	4993926.65
318	7410301.10	4993894.08
319	7410298.47	4993862.54
320	7410299.36	4993831.14
321	7410297.39	4993793.34
322	7410286.18	4993743.80

	Y [m]	X [m]
323	7410275.52	4993709.54
324	7410264.85	4993675.27
325	7410253.71	4993640.48
326	7410242.57	4993605.69
327	7410231.61	4993570.49
328	7410220.64	4993535.29
329	7410211.18	4993505.38
330	7410197.22	4993461.69
331	7410185.80	4993425.10
332	7410174.61	4993388.70
333	7410163.56	4993352.51
334	7410152.42	4993316.49
335	7410138.41	4993276.72
336	7410124.41	4993236.95
337	7410113.01	4993196.19
338	7410101.61	4993155.43
339	7410091.87	4993116.97
340	7410079.36	4993068.58
341	7410066.08	4993017.55
342	7410053.92	4992971.84
343	7410047.10	4992943.88
344	7410042.04	4992923.16
345	7410030.62	4992874.61
346	7410017.78	4992826.27
347	7410003.61	4992778.43
348	7409990.12	4992730.31
349	7409977.10	4992682.46
350	7409972.24	4992664.55
351	7409969.30	4992654.71
352	7409966.04	4992643.81
353	7409957.25	4992613.80
354	7409950.92	4992591.96
355	7409945.35	4992572.96
356	7409939.03	4992551.48
357	7409932.19	4992528.34
358	7409927.40	4992512.26
359	7409920.96	4992490.61
360	7409908.88	4992449.60
361	7409902.17	4992426.40
362	7409895.94	4992404.66
363	7409889.72	4992382.22
364	7409883.66	4992359.73
365	7409877.36	4992337.32
366	7409871.89	4992318.96
367	7409865.29	4992296.82
368	7409855.65	4992263.60

	Y [m]	X [m]
369	7409850.28	4992245.05
370	7409844.08	4992223.47
371	7409835.16	4992192.76
372	7409828.93	4992171.75
373	7409827.50	4992166.94
374	7409823.23	4992152.52
375	7409821.94	4992148.14
376	7409814.01	4992120.72
377	7409806.08	4992093.31
378	7409798.68	4992066.99
379	7409791.29	4992040.67
380	7409781.82	4992008.52
381	7409772.89	4991977.18
382	7409758.47	4991930.41
383	7409744.04	4991883.65
384	7409732.14	4991841.02
385	7409718.37	4991789.25
386	7409712.98	4991769.95
387	7409698.47	4991722.08
388	7409686.60	4991680.75
389	7409676.34	4991645.01
390	7409666.07	4991609.26
391	7409655.40	4991572.70
392	7409643.05	4991529.92
393	7409628.90	4991481.97
394	7409619.44	4991449.51
395	7409609.98	4991417.05
396	7409601.44	4991388.18
397	7409593.08	4991359.19
398	7409584.72	4991330.21
399	7409572.76	4991290.00
400	7409559.47	4991243.18
401	7409545.36	4991193.75
402	7409535.63	4991155.76
403	7409527.37	4991127.07
404	7409519.12	4991098.38
405	7409505.01	4991049.36
406	7409489.63	4991001.82
407	7409476.35	4990954.83
408	7409471.35	4990938.82
409	7409462.64	4990909.83
410	7409453.94	4990880.84
411	7409442.07	4990838.04
412	7409440.47	4990832.21
413	7409434.03	4990809.63
414	7409420.30	4990761.55

	Y [m]	X [m]
415	7409406.37	4990713.60
416	7409392.40	4990665.52
417	7409378.29	4990617.55
418	7409364.71	4990569.28
419	7409351.57	4990521.25
420	7409337.61	4990473.17
421	7409323.55	4990425.19
422	7409308.58	4990377.47
423	7409294.29	4990329.53
424	7409280.10	4990281.61
425	7409266.25	4990233.56
426	7409252.43	4990185.51
427	7409238.44	4990137.51
428	7409224.46	4990089.50
429	7409210.79	4990041.38
430	7409197.48	4989993.17
431	7409184.17	4989945.01
432	7409169.53	4989897.20
433	7409155.63	4989849.07
434	7409144.48	4989807.12
435	7409128.80	4989752.81
436	7409114.92	4989704.72
437	7409099.97	4989657.05
438	7409085.69	4989609.13
439	7409070.89	4989561.36
440	7409061.91	4989529.61
441	7409059.25	4989520.19
442	7409043.16	4989464.97
443	7409029.26	4989417.10
444	7409016.66	4989372.87
445	7408236.42	4999985.67
446	7408238.70	4999987.01
447	7408295.39	5000020.30
448	7408324.95	4999989.06
449	7408354.88	4999954.18
450	7408373.44	4999916.30
451	7408393.29	4999879.10
452	7408392.82	4999855.62
453	7408416.32	4999829.58
454	7408440.91	4999802.10
455	7408452.25	4999790.75
456	7408484.69	4999768.88
457	7408517.13	4999747.01
458	7408515.31	4999710.94
459	7408519.53	4999684.39
460	7408527.22	4999673.39

	Y [m]	X [m]
461	7408555.66	4999632.78
462	7408574.37	4999598.20
463	7408588.16	4999572.72
464	7408588.50	4999546.40
465	7408612.00	4999506.29
466	7408620.18	4999479.96
467	7408624.99	4999471.98
468	7408640.06	4999424.23
469	7408655.12	4999376.47
470	7408658.45	4999368.59
471	7408671.54	4999338.60
472	7408690.88	4999318.28
473	7408698.99	4999297.73
474	7408696.71	4999284.34
475	7408702.93	4999277.81
476	7408700.14	4999260.92
477	7408688.58	4999242.73
478	7408687.83	4999239.43
479	7408694.17	4999207.22
480	7408712.98	4999171.95
481	7408716.97	4999166.20
482	7408738.14	4999129.18
483	7408739.02	4999092.20
484	7408749.91	4999060.99
485	7408760.79	4999029.78
486	7408791.05	4998997.80
487	7408797.79	4998995.03
488	7408822.37	4998974.12
489	7408824.34	4998970.13
490	7408828.22	4998964.50
491	7408839.16	4998959.20
492	7408871.20	4998939.68
493	7408903.24	4998920.15
494	7408925.28	4998881.72
495	7408917.97	4998866.00
496	7408916.45	4998860.93
497	7408900.19	4998834.73
498	7408889.96	4998806.76
499	7408891.32	4998759.98
500	7408907.77	4998727.46
501	7408918.97	4998709.23
502	7408930.78	4998674.20
503	7408942.59	4998639.18
504	7408960.44	4998590.91
505	7408963.09	4998583.76
506	7408972.96	4998560.03

	Y [m]	X [m]
507	7408990.73	4998521.23
508	7409003.75	4998494.91
509	7409024.36	4998453.22
510	7409028.89	4998454.55
511	7409038.07	4998450.08
512	7409059.65	4998437.86
513	7409080.22	4998408.87
514	7409103.00	4998370.65
515	7409125.78	4998332.43
516	7409135.12	4998297.44
517	7409149.64	4998272.50
518	7409189.16	4998264.75
519	7409190.20	4998259.09
520	7409149.56	4998234.45
521	7409147.77	4998228.04
522	7409159.54	4998220.97
523	7409166.45	4998211.46
524	7409170.87	4998196.64
525	7409184.92	4998178.10
526	7409185.68	4998160.63
527	7409199.33	4998112.60
528	7409226.64	4998086.55
529	7409241.64	4998068.35
530	7409242.37	4998065.64
531	7409246.11	4998041.82
532	7409252.13	4998031.72
533	7409261.53	4998016.61
534	7409269.38	4998004.00
535	7409274.34	4997996.02
536	7409273.54	4997991.53
537	7409268.09	4997961.13
538	7409264.09	4997938.79
539	7409279.18	4997910.79
540	7409317.12	4997899.01
541	7409320.96	4997891.94
542	7409325.71	4997883.20
543	7409329.59	4997852.74
544	7409349.76	4997807.92
545	7409366.07	4997764.92
546	7409382.38	4997721.92
547	7409416.35	4997686.38
548	7409415.59	4997681.94
549	7409393.48	4997665.78
550	7409384.66	4997632.44
551	7409383.29	4997615.01
552	7409386.14	4997608.05

	Y [m]	X [m]
553	7409389.27	4997602.50
554	7409391.35	4997595.31
555	7409393.68	4997589.60
556	7409408.56	4997553.93
557	7409416.60	4997535.70
558	7409434.02	4997505.18
559	7409444.82	4997462.56
560	7409457.80	4997419.17
561	7409460.50	4997409.17
562	7409465.12	4997397.07
563	7409484.04	4997360.42
564	7409492.29	4997340.89
565	7409497.93	4997305.73
566	7409509.34	4997254.06
567	7409515.93	4997248.10
568	7409525.74	4997204.83
569	7409535.65	4997161.07
570	7409546.23	4997116.11
571	7409552.40	4997100.20
572	7409571.45	4997093.44
573	7409587.46	4997074.07
574	7409592.12	4997044.89
575	7409595.37	4997008.78
576	7409601.07	4996993.43
577	7409598.25	4996992.76
578	7409591.09	4996985.76
579	7409591.40	4996970.68
580	7409594.90	4996939.91
581	7409603.52	4996911.64
582	7409612.15	4996883.37
583	7409617.88	4996869.73
584	7409623.26	4996854.78
585	7409627.45	4996805.88
586	7409634.52	4996772.08
587	7409643.54	4996734.83
588	7409654.07	4996691.24
589	7409664.60	4996647.65
590	7409672.70	4996615.06
591	7409686.12	4996565.28
592	7409692.95	4996538.81
593	7409703.64	4996513.80
594	7409712.98	4996463.39
595	7409713.84	4996459.94
596	7409722.15	4996427.53
597	7409730.47	4996395.12
598	7409740.16	4996357.34

	Y [m]	X [m]
599	7409751.90	4996311.54
600	7409761.55	4996268.31
601	7409771.19	4996225.08
602	7409778.43	4996194.25
603	7409779.54	4996173.87
604	7409783.80	4996156.44
605	7409789.51	4996135.30
606	7409794.36	4996117.32
607	7409805.97	4996084.75
608	7409806.31	4996081.67
609	7409809.01	4996065.34
610	7409819.56	4996016.49
611	7409828.09	4995970.40
612	7409843.12	4995924.33
613	7409858.16	4995878.25
614	7409870.42	4995848.14
615	7409886.90	4995815.21
616	7409903.37	4995782.28
617	7409924.08	4995751.87
618	7409944.79	4995721.47
619	7409953.63	4995709.48
620	7409963.98	4995695.84
621	7409968.10	4995691.65
622	7409970.95	4995688.95
623	7409972.86	4995682.76
624	7409993.50	4995685.39
625	7410006.16	4995681.81
626	7410015.00	4995677.51
627	7410040.47	4995652.95
628	7410051.92	4995634.99
629	7410083.42	4995618.45
630	7410081.38	4995603.27
631	7410063.99	4995591.31
632	7410073.87	4995580.78
633	7410089.68	4995563.92
634	7410095.40	4995558.11
635	7410101.30	4995552.13
636	7410115.24	4995537.98
637	7410128.50	4995524.70
638	7410141.75	4995511.85
639	7410159.71	4995494.44
640	7410177.67	4995477.02
641	7410191.41	4995463.37
642	7410203.25	4995450.94
643	7410227.68	4995423.92
644	7410231.84	4995419.33

	Y [m]	X [m]
645	7410243.57	4995406.10
646	7410251.67	4995396.64
647	7410262.76	4995383.42
648	7410281.10	4995358.01
649	7410278.68	4995355.60
650	7410292.38	4995336.91
651	7410293.87	4995334.95
652	7410307.23	4995317.13
653	7410309.88	4995319.46
654	7410322.47	4995298.90
655	7410331.76	4995282.43
656	7410338.42	4995269.86
657	7410344.88	4995256.65
658	7410348.19	4995251.24
659	7410353.76	4995239.95
660	7410358.24	4995232.82
661	7410363.30	4995221.22
662	7410375.93	4995191.18
663	7410378.23	4995185.18
664	7410383.65	4995166.85
665	7410395.63	4995131.62
666	7410397.41	4995126.54
667	7410401.36	4995109.39
668	7410412.16	4995062.39
669	7410413.31	4995057.96
670	7410414.77	4995052.23
671	7410416.32	4995042.26
672	7410419.78	4995019.90
673	7410424.59	4994988.88
674	7410427.35	4994973.58
675	7410429.64	4994963.14
676	7410431.97	4994950.47
677	7410433.08	4994940.01
678	7410437.13	4994907.28
679	7410441.35	4994874.57
680	7410444.88	4994833.84
681	7410448.68	4994807.95
682	7410454.74	4994768.89
683	7410457.94	4994745.00
684	7410460.03	4994729.83
685	7410462.30	4994715.74
686	7410464.52	4994699.22
687	7410466.13	4994685.56
688	7410467.75	4994671.81
689	7410469.59	4994656.23
690	7410471.37	4994641.63

	Y [m]	X [m]
691	7410473.19	4994626.66
692	7410474.88	4994612.70
693	7410477.37	4994597.17
694	7410481.82	4994570.74
695	7410484.67	4994555.80
696	7410505.17	4994510.36
697	7410528.32	4994490.24
698	7410537.45	4994483.15
699	7410561.40	4994454.83
700	7410566.53	4994425.35
701	7410585.87	4994397.07
702	7410613.56	4994406.57
703	7410622.55	4994412.90
704	7410635.34	4994395.46
705	7410600.05	4994370.86
706	7410583.33	4994358.86
707	7410575.46	4994319.73
708	7410560.85	4994301.20
709	7410541.46	4994290.01
710	7410531.57	4994281.48
711	7410523.48	4994272.06
712	7410521.75	4994259.85
713	7410520.99	4994254.53
714	7410519.47	4994238.29
715	7410516.69	4994199.77
716	7410511.00	4994148.93
717	7410506.04	4994116.92
718	7410496.48	4994083.57
719	7410484.55	4994040.73
720	7410470.76	4994018.30
721	7410468.44	4994014.53
722	7410458.07	4993997.65
723	7410445.10	4993961.44
724	7410428.72	4993912.66
725	7410413.86	4993866.22
726	7410404.68	4993833.00
727	7410399.96	4993817.18
728	7410396.93	4993806.37
729	7410393.97	4993798.76
730	7410390.35	4993788.91
731	7410388.93	4993777.43
732	7410387.68	4993751.27
733	7410388.89	4993739.64
734	7410394.25	4993714.31
735	7410395.41	4993688.18
736	7410386.86	4993655.48

	Y [m]	X [m]
737	7410380.21	4993633.43
738	7410373.75	4993612.90
739	7410368.68	4993603.78
740	7410363.63	4993600.59
741	7410347.52	4993591.41
742	7410328.28	4993581.27
743	7410318.32	4993566.33
744	7410313.68	4993547.41
745	7410302.75	4993502.95
746	7410296.12	4993476.09
747	7410283.65	4993427.08
748	7410270.74	4993378.36
749	7410257.17	4993330.18
750	7410243.20	4993282.14
751	7410228.62	4993234.34
752	7410222.80	4993204.46
753	7410216.97	4993174.58
754	7410237.39	4993168.90
755	7410232.45	4993150.62
756	7410203.88	4993151.63
757	7410194.93	4993122.50
758	7410187.05	4993089.49
759	7410171.63	4993041.58
760	7410157.54	4992997.82
761	7410142.46	4992950.08
762	7410130.14	4992912.93
763	7410118.99	4992879.14
764	7410105.85	4992840.17
765	7410092.04	4992797.27
766	7410076.36	4992746.68
767	7410060.39	4992696.14
768	7410045.92	4992645.18
769	7410031.65	4992594.16
770	7410016.26	4992543.40
771	7410000.60	4992492.71
772	7409989.47	4992452.27
773	7409980.08	4992413.93
774	7409975.64	4992394.47
775	7409968.17	4992381.51
776	7409961.84	4992363.11
777	7409957.29	4992345.53
778	7409955.03	4992337.64
779	7409950.68	4992322.40
780	7409946.11	4992306.41
781	7409941.23	4992290.29
782	7409939.28	4992282.57

	Y [m]	X [m]
783	7409935.97	4992272.34
784	7409931.25	4992256.08
785	7409927.24	4992242.29
786	7409919.76	4992216.21
787	7409914.93	4992199.19
788	7409910.10	4992182.15
789	7409904.48	4992163.37
790	7409900.08	4992148.70
791	7409887.04	4992103.27
792	7409883.75	4992090.53
793	7409879.17	4992075.19
794	7409874.82	4992059.64
795	7409870.12	4992042.83
796	7409865.65	4992027.23
797	7409860.94	4992010.98
798	7409856.87	4991996.91
799	7409854.58	4991989.01
800	7409852.31	4991981.32
801	7409847.93	4991966.49
802	7409842.78	4991949.01
803	7409840.60	4991941.64
804	7409835.98	4991925.82
805	7409833.36	4991916.84
806	7409824.42	4991886.38
807	7409818.87	4991867.49
808	7409811.71	4991843.75
809	7409798.74	4991797.59
810	7409785.32	4991747.66
811	7409780.62	4991732.23
812	7409770.92	4991700.34
813	7409766.14	4991684.52
814	7409761.17	4991668.08
815	7409756.46	4991652.44
816	7409751.93	4991636.21
817	7409747.65	4991620.87
818	7409742.94	4991604.10
819	7409740.64	4991596.66
820	7409738.00	4991588.13
821	7409727.45	4991553.82
822	7409722.22	4991535.60
823	7409718.04	4991521.06
824	7409713.04	4991504.11
825	7409707.44	4991486.33
826	7409695.83	4991448.62
827	7409690.71	4991431.25
828	7409685.55	4991413.73

	Y [m]	X [m]
829	7409680.58	4991394.98
830	7409675.61	4991376.23
831	7409670.67	4991357.90
832	7409665.78	4991340.18
833	7409661.15	4991323.41
834	7409655.30	4991303.04
835	7409647.69	4991276.99
836	7409642.22	4991257.89
837	7409634.34	4991229.98
838	7409629.22	4991212.19
839	7409626.63	4991203.44
840	7409621.09	4991184.66
841	7409615.46	4991165.51
842	7409610.31	4991147.94
843	7409604.49	4991128.06
844	7409599.21	4991110.00
845	7409594.20	4991092.87
846	7409588.91	4991074.74
847	7409583.76	4991056.89
848	7409578.31	4991038.01
849	7409570.62	4991011.14
850	7409562.76	4990983.51
851	7409557.77	4990966.18
852	7409554.85	4990956.07
853	7409545.35	4990923.41
854	7409536.61	4990893.87
855	7409531.60	4990876.96
856	7409525.47	4990856.91
857	7409522.70	4990847.85
858	7409515.05	4990822.16
859	7409512.32	4990812.89
860	7409510.01	4990804.35
861	7409506.56	4990793.39
862	7409501.63	4990777.14
863	7409492.94	4990748.75
864	7409488.10	4990731.60
865	7409483.31	4990713.79
866	7409478.11	4990693.79
867	7409472.34	4990675.61
868	7409463.83	4990649.04
869	7409458.54	4990631.00
870	7409450.52	4990602.93
871	7409445.51	4990585.75
872	7409442.75	4990576.37
873	7409434.54	4990548.41
874	7409427.10	4990520.55

	Y [m]	X [m]
875	7409423.25	4990506.13
876	7409421.91	4990493.96
877	7409420.04	4990487.18
878	7409414.75	4990475.51
879	7409411.34	4990463.33
880	7409407.92	4990451.16
881	7409394.50	4990404.60
882	7409384.85	4990371.83
883	7409373.23	4990332.66
884	7409361.62	4990292.88
885	7409352.47	4990260.60
886	7409339.11	4990214.11
887	7409324.22	4990163.78
888	7409314.22	4990127.93
889	7409302.74	4990090.31
890	7409288.98	4990044.71
891	7409275.24	4989998.74
892	7409264.63	4989961.42
893	7409254.18	4989924.69
894	7409240.93	4989876.47
895	7409227.10	4989828.44
896	7409212.77	4989780.53
897	7409199.17	4989732.42
898	7409187.43	4989683.76
899	7409182.58	4989663.66
900	7409181.85	4989660.09
901	7409169.95	4989623.99
902	7409158.05	4989587.88
903	7409150.87	4989556.23
904	7409143.69	4989524.58
905	7409134.56	4989497.55
906	7409125.43	4989470.52
907	7409119.35	4989447.63
908	7409109.75	4989416.34
909	7409100.89	4989385.01
910	7409089.24	4989341.78
911	7409079.14	4989299.15
912	7409069.30	4989254.37
913	7409070.99	4989216.45
914	7410397.71	4994058.81
915	7410393.00	4994043.31
916	7410384.51	4994018.10
917	7410370.69	4993994.30
918	7410361.75	4993981.15
919	7410347.07	4993959.55
920	7410328.93	4993921.38

	Y [m]	X [m]
921	7410319.95	4993881.62
922	7410319.94	4993842.68
923	7410320.94	4993824.82
924	7410319.49	4993786.87
925	7410333.24	4993821.22
926	7410338.99	4993836.48
927	7410349.59	4993878.77
928	7410362.42	4993924.10
929	7410372.15	4993950.76
930	7410380.82	4993974.15
931	7410386.60	4993988.66
932	7410392.84	4994015.11
933	7410397.69	4994041.62
934	7410400.53	4994057.80
935	7410365.23	4993757.84
936	7410361.08	4993747.77
937	7410343.47	4993703.33
938	7410333.21	4993687.20
939	7410326.11	4993662.12
940	7410319.29	4993638.06
941	7410316.81	4993629.31
942	7410314.09	4993619.69
943	7410313.60	4993599.33
944	7410341.95	4993611.54
945	7410352.72	4993618.81
946	7410358.63	4993626.52
947	7410365.46	4993650.61
948	7410372.56	4993675.69
949	7410374.24	4993694.33
950	7410367.10	4993746.01

.		
	Y [m]	X [m]
1	7408677.09	5004060.40
2	7408634.40	5004032.92
3	7408598.00	5004007.39
4	7408562.19	5003971.70
5	7408526.76	5003936.40
6	7408490.26	5003902.23
7	7408447.93	5003874.12
8	7408404.18	5003847.49
9	7408363.52	5003825.05
10	7408338.65	5003801.66
11	7408325.89	5003782.62
12	7408306.08	5003746.95
13	7408277.08	5003719.57
14	7408239.99	5003699.72
15	7408216.99	5003687.59
16	7408210.76	5003682.98
17	7408186.42	5003647.04
18	7408186.38	5003632.23
19	7408165.14	5003591.44
20	7408131.09	5003557.66
21	7408116.28	5003537.48
22	7408112.05	5003525.19
23	7408107.36	5003522.24
24	7408097.84	5003498.89
25	7408075.22	5003451.69
26	7408047.80	5003409.78
27	7408040.32	5003396.42
28	7408039.88	5003372.01
29	7408083.82	5003361.18
30	7408099.46	5003358.63
31	7408153.16	5003349.86
32	7408155.88	5003348.52
33	7408184.00	5003362.74
34	7408211.20	5003400.80
35	7408229.62	5003446.03
36	7408237.59	5003493.97
37	7408249.44	5003546.59
38	7408256.26	5003569.15
39	7408279.53	5003598.08
40	7408302.79	5003627.00
41	7408326.15	5003655.26
42	7408349.50	5003683.51
43	7408375.06	5003708.84
44	7408400.62	5003734.17
45	7408436.40	5003766.03

.		
	Y [m]	X [m]
46	7408476.09	5003797.88
47	7408515.31	5003829.46
48	7408553.84	5003863.25
49	7408588.33	5003897.82
50	7408621.96	5003930.48
51	7408654.12	5003952.61
52	7408686.29	5003974.73
53	7408722.73	5004004.44
54	7408705.19	5004025.65
55	7408700.90	5004030.89
56	7408693.86	5004039.49
57	7408684.74	5004050.99



	Y [m]	X [m]	H [m]	
1	7414975.219	5019081.609	83.101	
2	7414534.869	5018950.719	82.613	
3	7414778.573	5018994.637	89.236	
4	7414978.701	5018816.197	81.928	
5	7415194.563	5018656.796	80.204	
6	7415115.367	5018459.279	78.563	
7	7415089.417	5018228.962	74.060	
8	7415206.953	5018057.550	73.932	
9	7415257.061	5017830.574	74.764	
10	7415369.598	5017659.731	75.977	
11	7415463.253	5017461.727	75.000	
12	7415462.715	5017196.221	75.146	
13	7415443.783	5016928.874	75.557	
14	7415436.600	5016664.240	75.761	
15	7415360.973	5016370.305	76.263	
15A	7415327.766	5016462.748	75.290	
15B	7415182.139	5016303.997	75.953	
16	7415317.703	5016090.348	76.514	
17	7415283.905	5015941.448	79.180	
18	7415385.024	5015751.374	79.233	
19	7415228.637	5015448.530	76.975	
20	7415258.326	5015222.049	76.012	
21	7415308.449	5014969.741	75.255	III
22	7415392.434	5014665.320	74.569	III
23	7415273.730	5014416.208	75.133	III
24	7415147.136	5014195.769	74.112	III
25	7415029.025	5013958.995	74.544	III
26	7414949.502	5013721.262	74.453	III
27	7414862.343	5013527.251	74.066	III
28	7414732.742	5013334.903	73.705	III
28A	7414702.669	5013580.658	74.058	III
29	7414588.807	5012994.380	80.522	III
30	7414501.098	5012872.504	74.242	III
31	7414206.745	5012403.834	75.143	
32	7414126.140	5012301.506	75.943	
33	7411349.117	5013418.590	85.797	
34	7411564.905	5013304.842	84.242	
35	7411794.313	5013199.128	83.021	
36	7412028.561	5013076.877	81.800	
37	7412274.785	5012960.691	81.836	
38	7412492.955	5012820.316	78.760	
39	7412734.046	5012746.045	78.202	
40	7412987.301	5012675.072	77.813	
41	7413257.065	5012604.874	77.194	
42	7413463.081	5012505.250	77.940	
43	7413677.375	5012327.633	77.990	
44	7413810.835	5012194.020	80.482	

	Y [m]	X [m]	H [m]	
45	7413955.522	5012070.875	80.731	
46	7414034.210	5011823.232	80.266	
47	7413948.979	5011606.172	77.682	
48	7413928.618	5011347.908	80.264	
49	7413921.944	5011085.835	80.150	
50	7413971.478	5010837.274	80.143	
51	7414002.580	5010578.989	80.240	
52	7413943.189	5010327.444	80.392	
53	7413817.740	5010137.777	80.686	
54	7413644.624	5010110.147	93.155	
55	7413470.279	5010112.023	114.406	
56	7413316.426	5010126.771	118.745	
57	7413227.039	5010117.442	117.510	
58	7413021.966	5010057.348	96.215	
59	7412833.813	5010040.854	98.106	
60	7412721.323	5010085.625	101.040	
61	7412526.669	5009902.697	104.609	
62	7412401.236	5009685.771	108.830	
63	7412226.275	5009493.896	115.316	
64	7411967.996	5009390.139	121.141	
65	7411789.092	5009310.445	125.915	
66	7411660.606	5009205.374	131.004	
67	7411450.720	5008966.135	140.591	
68	7411196.539	5008812.036	148.867	
69	7411042.707	5008685.811	154.165	.
70	7410857.385	5008580.005	159.987	.
71	7410632.196	5008531.352	165.843	.
72	7410517.748	5008469.917	169.013	.
73	7410416.082	5008350.667	172.368	.
74	7410271.055	5008229.237	182.350	.
75	7410073.951	5008285.134	176.442	.
76	7409944.376	5008263.585	168.845	.
77	7409729.899	5008017.499	158.166	.
78	7409649.574	5007887.528	155.519	.
79	7409642.050	5007737.854	152.119	.
80	7409656.327	5007556.563	149.070	.
81	7409532.972	5007365.923	143.552	.
82	7409478.972	5007149.827	136.013	.
83	7409500.751	5006897.750	131.651	.
84	7409441.660	5006621.996	134.398	.
85	7409387.970	5006426.802	138.210	.
86	7409362.818	5006177.322	142.860	.
87	7409339.651	5005825.041	149.508	.
88	7409301.758	5005563.921	154.278	.
89	7409263.863	5005281.790	159.009	.
90	7409249.691	5005054.056	163.446	.
91	7409207.367	5004800.580	167.833	.

	Y [m]	X [m]	H [m]	
92	7409161.114	5004572.777	174.553	.
93	7409121.939	5004423.955	179.815	.
94	7409001.936	5004330.239	184.361	.
95	7408843.953	5004136.095	190.832	.
96	7408621.099	5004000.544	201.181	.
97	7408493.056	5003874.094	208.110	.
98	7408352.781	5003808.629	215.889	.
99	7408306.049	5003738.705	220.872	.
100	7408195.763	5003688.371	229.022	.
101	7408144.917	5003574.115	238.388	.
102	7408062.007	5003440.569	251.296	.
103	7408103.428	5003354.780	260.312	.
104	7408086.714	5003258.946	268.455	.
112	7408297.199	4999772.821	322.838	
113	7408382.293	4999720.120	311.426	
114	7408487.448	4999628.994	305.200	
115	7408600.803	4999429.290	299.000	
116	7408656.963	4999286.760	279.742	
117	7408709.604	4999082.664	278.745	
118	7408925.883	4998931.521	263.083	
119	7408902.606	4998686.896	329.890	
120	7408866.965	4998624.746	335.092	
121	7408998.899	4998510.179	305.059	
122	7409099.578	4998352.844	259.790	
123	7409130.739	4998180.307	260.444	
124	7409140.229	4998009.225	258.300	
125	7409263.564	4997876.544	240.820	
126	7409456.929	4997660.578	219.823	
127	7409565.290	4997362.626	216.049	
128	7409609.320	4997072.641	213.990	
129	7409730.069	4996816.419	199.952	
130	7409805.843	4996693.301	198.532	
131	7409654.838	4996584.425	224.159	
132	7409700.141	4996402.613	220.931	
133	7409798.253	4996093.292	214.877	
134	7409830.983	4995923.245	211.495	
135	7409890.555	4995786.676	208.298	
136	7410035.634	4995602.015	202.305	
137	7410266.294	4995362.613	197.781	
138	7410374.168	4995163.152	195.520	
139	7410428.608	4994938.926	190.894	
140	7410453.107	4994679.227	186.784	
141	7410486.007	4994419.293	183.263	
142	7410492.379	4994312.764	179.998	
143	7410434.576	4994115.621	177.237	
144	7410364.842	4993876.210	179.795	
145	7410268.891	4993547.822	175.518	

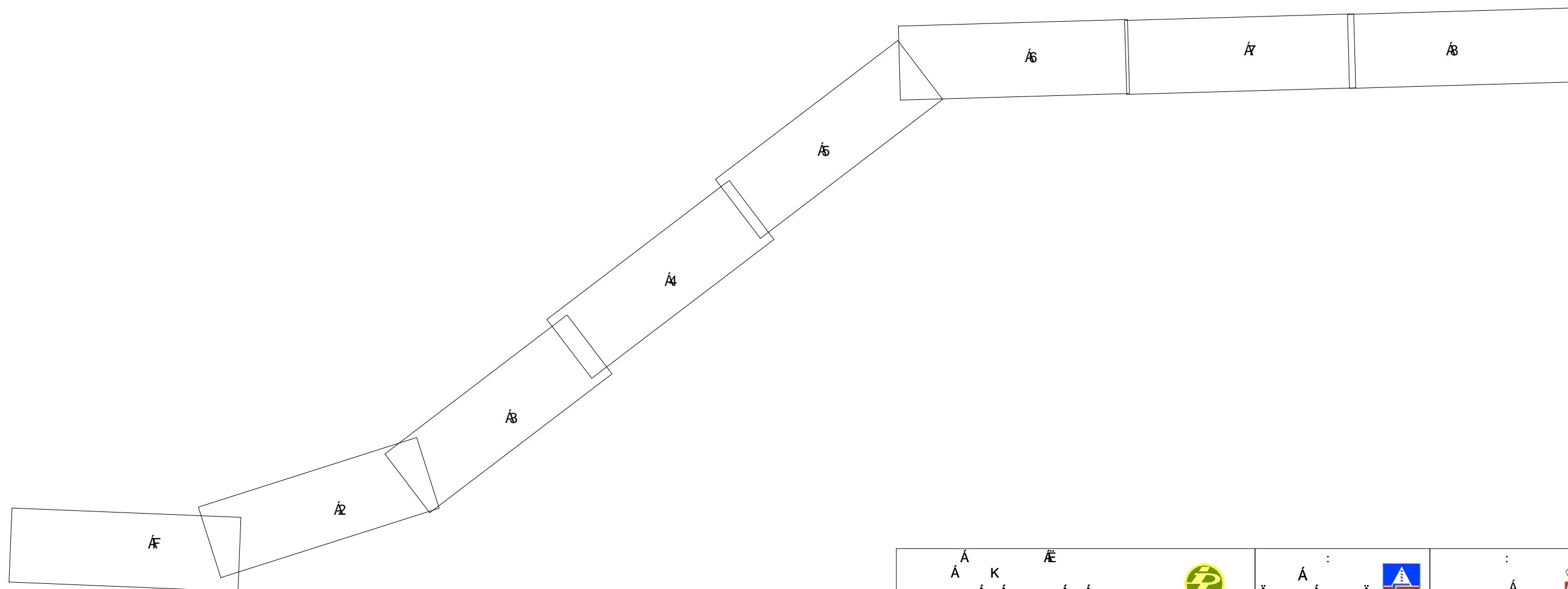
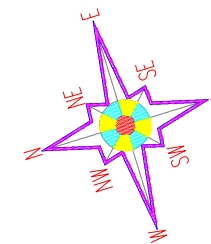
	Y [m]	X [m]	H [m]	
146	7410185.233	4993273.233	172.582	
147	7410119.038	4993033.993	170.456	
148	7410050.184	4992745.522	164.991	
149	7409964.104	4992497.598	161.672	
150	7409914.987	4992270.385	161.170	
151	7409822.278	4992010.520	158.568	
152	7409752.828	4991782.158	156.890	
153	7409692.179	4991563.097	153.844	
154	7409604.790	4991272.928	149.901	
155	7409543.861	4991051.104	147.847	
156	7409495.233	4990829.852	144.780	
157	7409436.535	4990681.288	144.750	
158	7409382.020	4990423.901	142.579	
159	7409292.577	4990185.346	140.860	
160	7409239.623	4989947.170	139.298	
161	7409142.358	4989667.248	137.244	
162	7409092.727	4989442.004	134.793	
163	7409022.412	4989250.091	136.948	
164	7408955.871	4989040.916	136.050	
165	7408944.288	4988935.831	135.434	
166	7408864.012	4988709.656	133.277	
167	7408834.786	4988554.915	131.176	
168	7408747.634	4988325.317	131.810	
169	7408675.142	4988082.175	130.427	
170	7408626.836	4987852.862	130.580	
171	7408565.198	4987630.335	128.204	

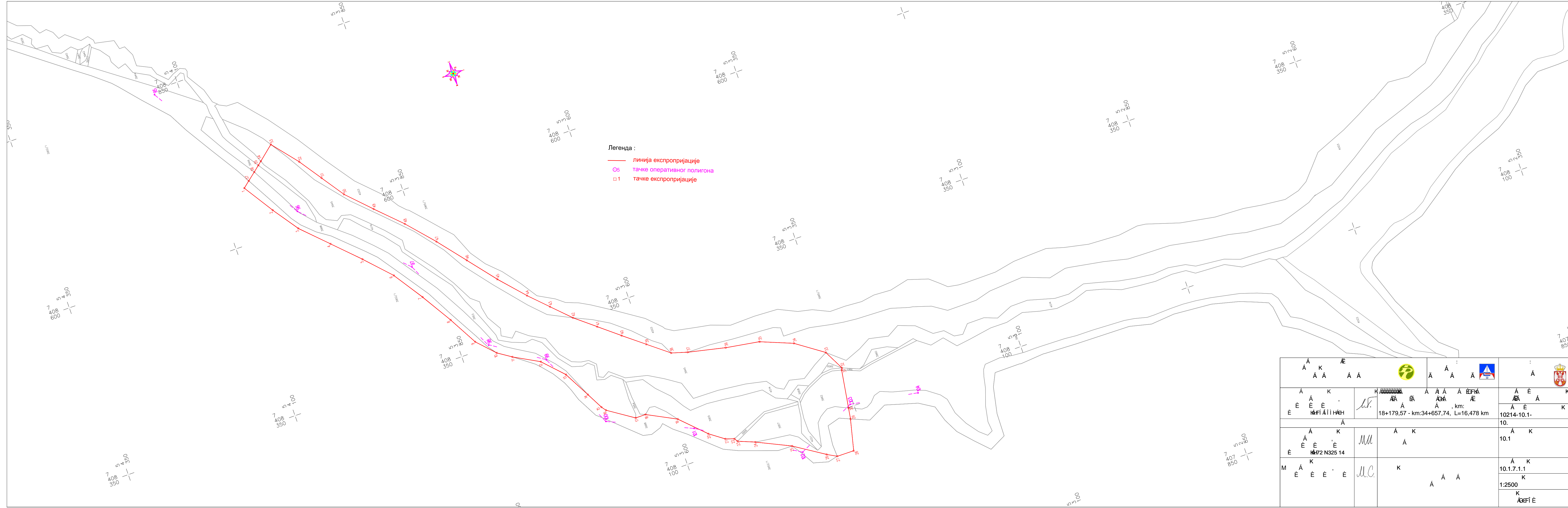

<p>Á Á K Æ</p> <p>Á Á Á Á Á Á</p> 	<p>:</p> <p>Á Á Á</p> 	<p>:</p> <p>Á</p> 
<p>Á K</p> <p>Á ,</p> <p>È È È</p> <p>È Ì Á Ì Ì Ì</p>	<p>K AAAAAAAAAA</p> <p>Á Á Á Á Á Á</p> <p>Á Á Á Á Á Á</p> <p>Á Á , km:</p> <p>18+179,57 - km:34+657,74, L=16,478 km</p>	<p>Á È K</p> <p>Á Á</p> <p>Á È K</p> <p>10214-10.1-</p>
<p>Á</p>		
<p>Á K</p> <p>Á ,</p> <p>È È È</p> <p>È Ì Á Ì Ì Ì</p> <p>172 N325 14</p>	<p>MM</p>	<p>Á K</p> <p>Á</p> <p>10.1</p>
<p>M K</p> <p>Á ,</p> <p>È È È È</p>	<p>U.C.</p>	<p>Á K</p> <p>10.1.7.1.0</p> <p>K</p> <p>Á È</p>

[illegible]

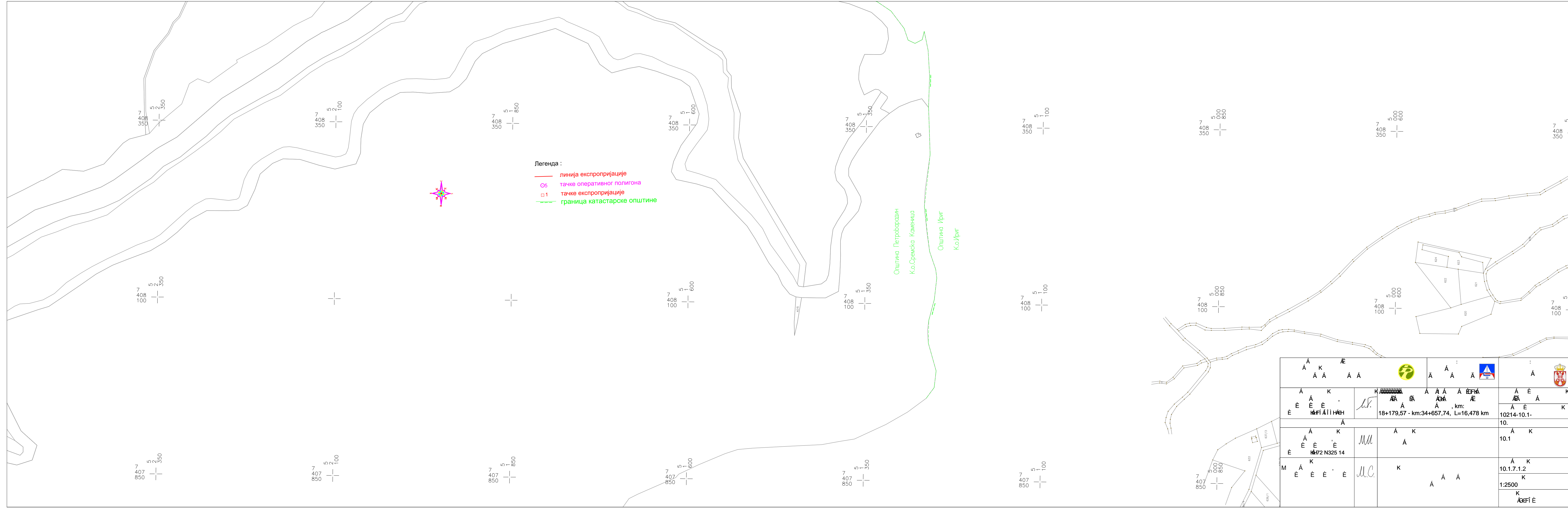

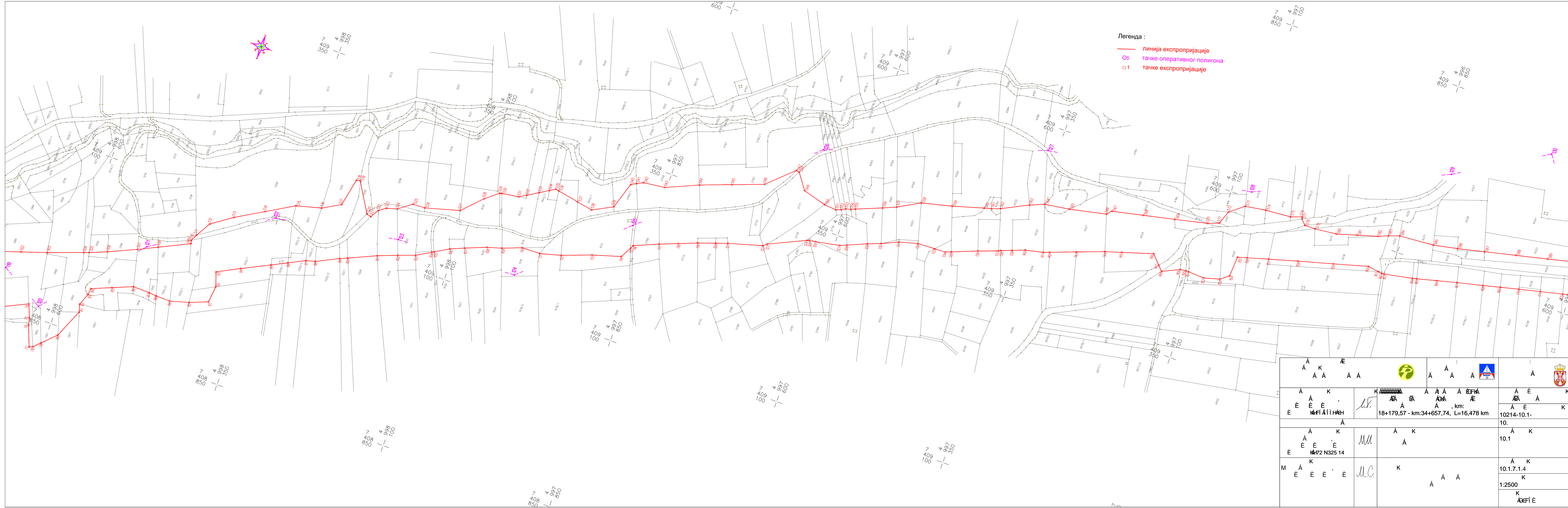

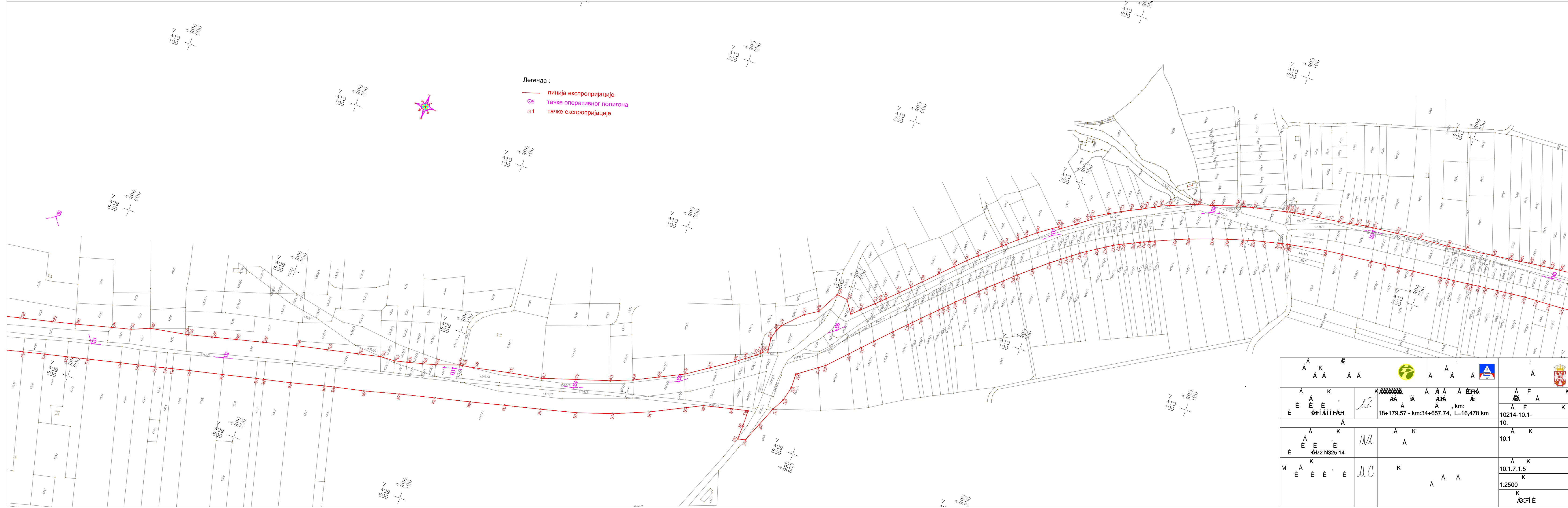
[illegible]

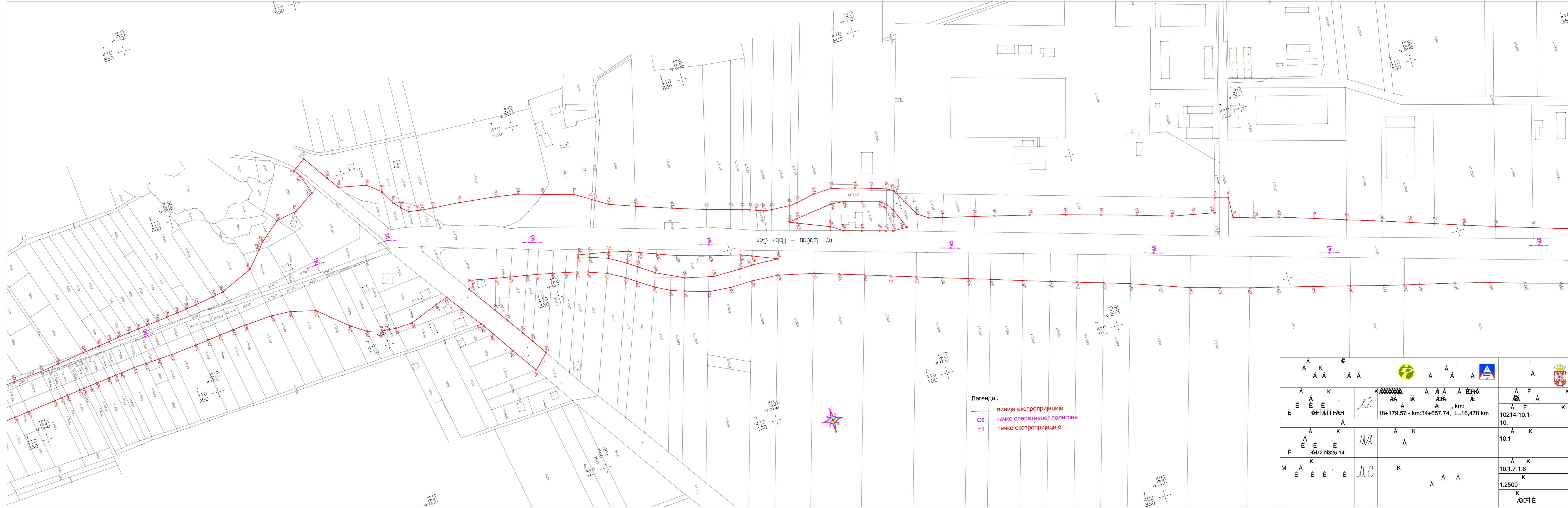
[illegible]

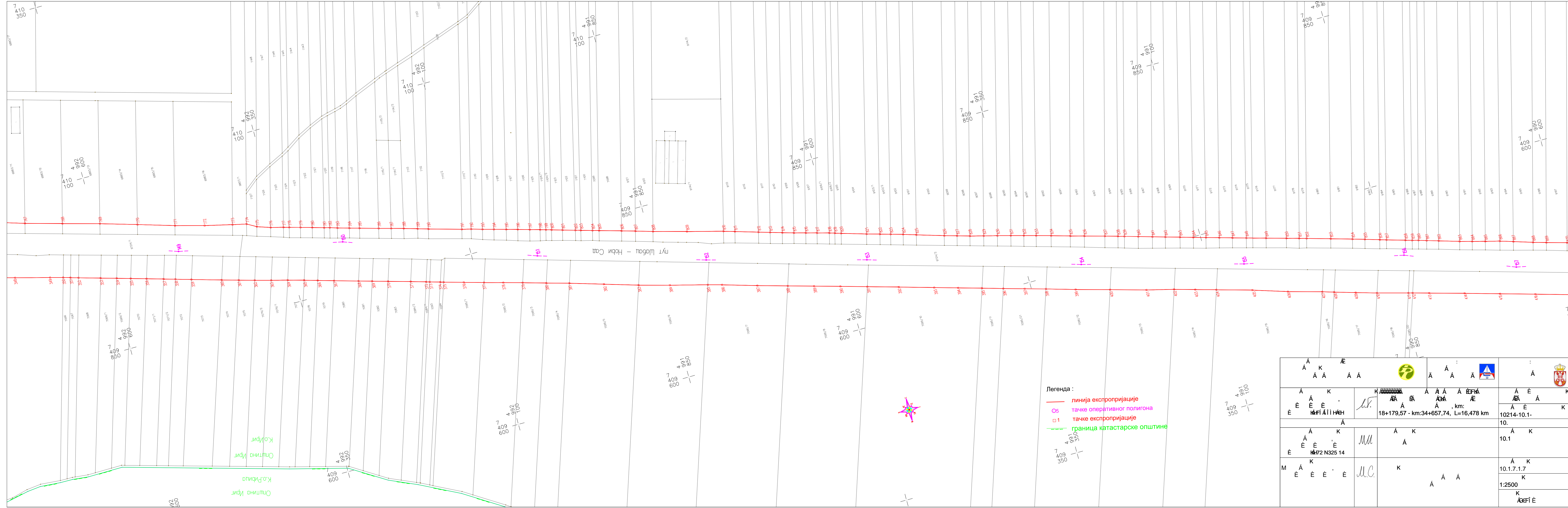
[illegible]

